

Afmetingen montageposities en accessoires

Deurdrangers zijn geschikt voor links- en rechtsdraaiende deuren.
 Afbeelding toont links- of rechtsdraaiende deur.
 Andere draairichting is in spiegelbeeld.

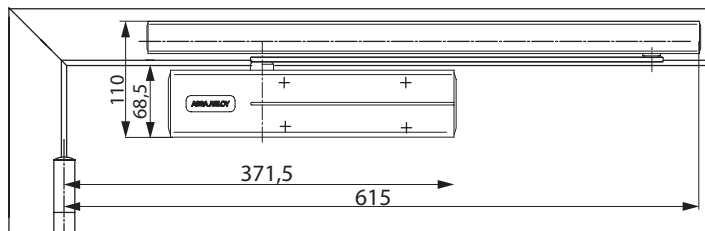

1-Deurbladmontage
scharnierzijde

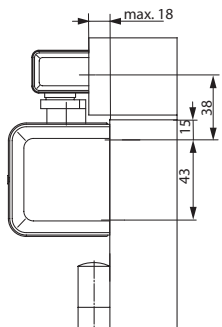
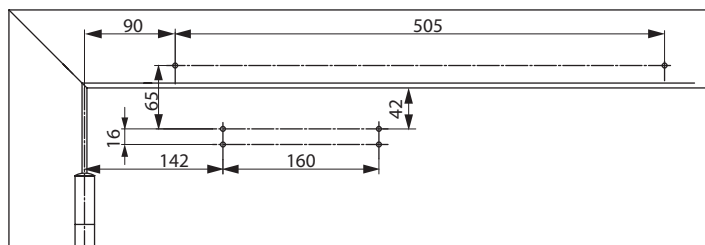
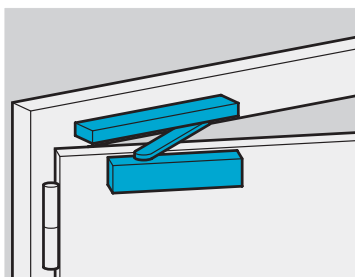

DC700 met
montageplaat A120

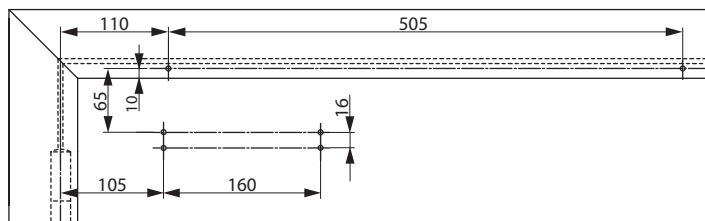
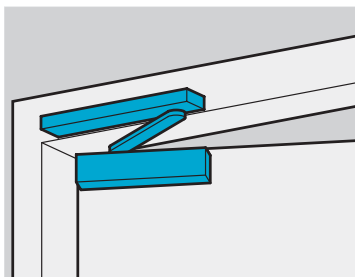

2 - Deurbladmontage
niet-scharnierzijde

DC700 met
montageplaat A120

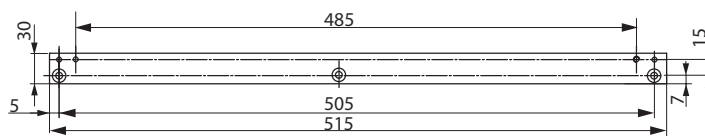
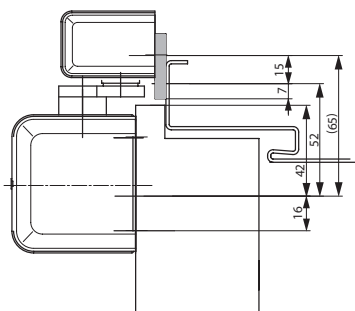

Vlakke montageplaat
A115
Voor glijarm G460.

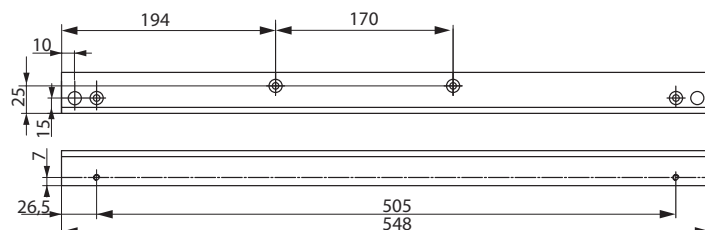
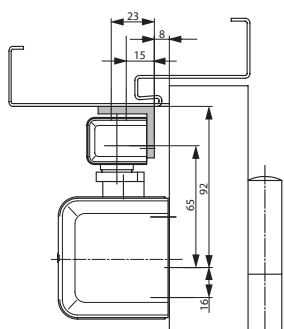

Hoekmontageplaat A116
Voor glijarm G460 op
niet-scharnierzijde.